

TECHNICAL DATASHEET - LPX100-1

topflo®



EHEDG compliant

Product images are for illustrative purposes only and may differ from the actual product.
Certificates may vary depending on the material execution of a particular product.

Materials, data and limits

Technical DATA	LPX100-1
Casing Material	Stainless Steel EN 10088-3/1.4404
Rotor Material	Stainless Steel EN 10088-3/1.4404
Shaft Material	Stainless Steel EN 10088-3/1.4404
Front Cover	Stainless Steel EN 10088-3/1.4404
Displacement [l/rev]	2.29
Connection size	100 (4")
Differential pressure rating [bar/]	10
Maximum pumps speed [rpm]	600
Input shaft diameter [mm/]	55
Maximum torque [N-M]	1200
Fittings Type	DIN 11851 Thread (Default)
Rotors Type	Trilobe In Stainless Steel
Shaft Seal	single mechanical seal SiC/SiC FDA (Default) options: double mechanical seal SiC/SiC FDA
O-ring Material	FKM FDA (Default) options: EPDM FDA
Shaft Position	horizontal: Shaft Top
Front Cover	standard or with a heating jacket
Paint	RAL 9010 - white
Documentation	
Seal Certification	FDA approved
Design	3A certified & conform EC 1935/2004



General performance curve

The performance curves are based on 500cP liquid.

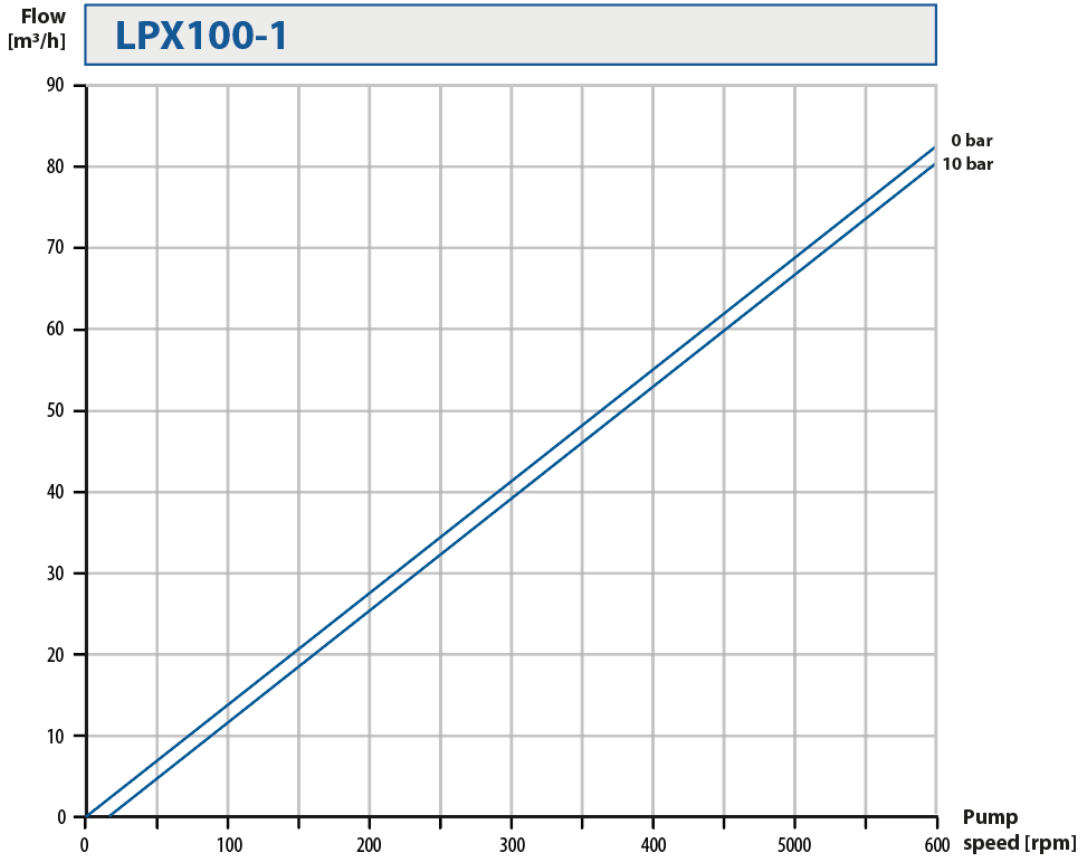

Overall pump dimensions

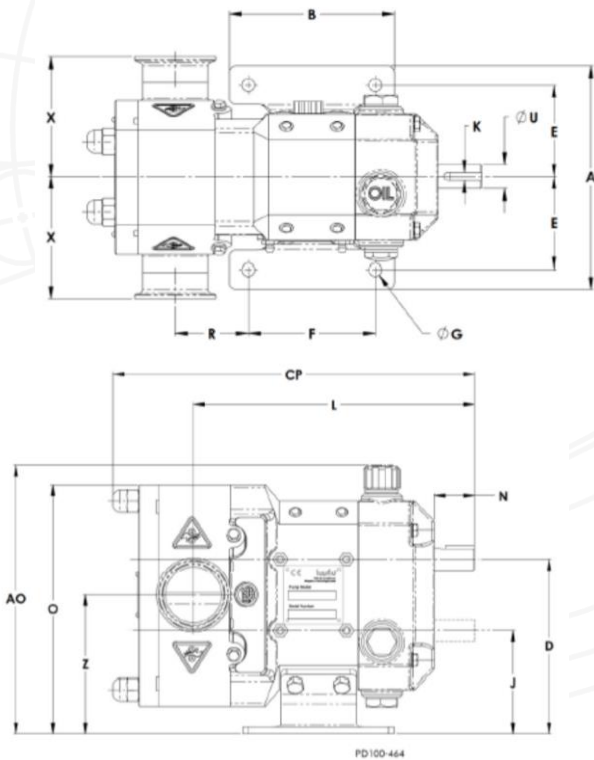

Dim	[mm]
A	301.1
AO	384.6
B	250.0
CP	553.6
D	263.7
E	130.5
F	210.0
G	13
J	138.7
K	16x10
L	437.0
N	85.6
O	368.2
R	81.5
U	55
X	159.0
Z	201.2

